



ALUMINIUM HOUSING

MS SERIES

THREE-PHASE ASYNCHRONOUS MOTORS

OPERATING CONDITIONS

- Ambient temperature: $-15^{\circ}\text{C} \leq \theta \leq 40^{\circ}\text{C}$
- Above sea level: not exceed 1000m
- Rated voltage: $\pm 5\%$
- Protection Class: IP44/IP54/IP55
- Insulation Class: B/F
- Cooling method: ICO141
- Duty: continuous(S)

IMB3

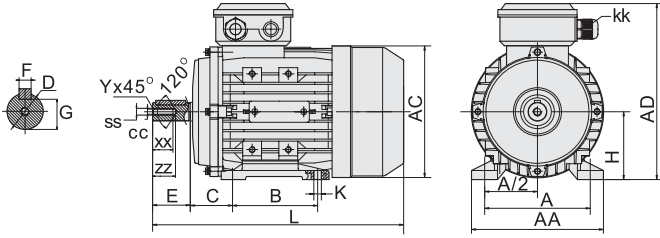

IMB5

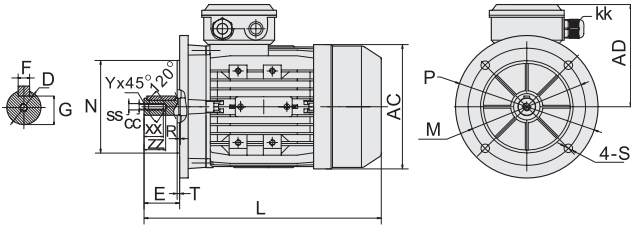

IMB14

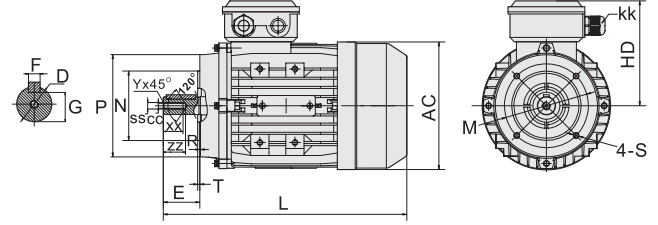

B3 OVERALL & INSTALLATION DIMENSION

Frame	H	A	B	C	D	E	F	G	K	AA	AD	AC	L	KK	SS	XX	ZZ	CC	Y
56	56	90	71	36	9	20	3	7.2	5.8X5.8	110	156/151	φ120	195	1-M16X1.5	M3	8	12	2.5	0.5
63	63	100	80	40	11	23	4	8.5	7X10	120	173/165	φ130	230	1-M16X1.5	M4	10	15	3.3	0.8
71**	71	112	90	45	14	30	5	11	7X10	132	188/180	φ145	260	1-M20X1.5	M5	12	18	4.2	0.8
80	80	125	100	50	19	40	6	15.5	10X13	160	217	φ165	295	1-M20X1.5	M6	16	22	5	1
90S	90	140	100	56	24	50	8	20	10X13	175	235	φ185	335	1-M20X1.5	M8	20	25	6.8	1
90L1/L2	90	140	125	56	24	50	8	20	10X13	175	235	φ185	365	1-M20X1.5	M8	20	25	6.8	1
100**	100	160	140	63	28	60	8	24	12X16	196	252	φ205	400	1-M20X1.5	M10	22	28	8.5	1.5
112	112	190	140	70	28	60	8	24	12X16	220	292	φ230	400	2-M25X1.5	M10	22	28	8.5	1.5
132S	132	216	140	89	38	80	10	33	12X16	252	325	φ270	510	2-M25X1.5	M12	28	34	10.2	1.5
132M/L	132	216	178	89	38	80	10	33	12X16	252	325	φ270	510	2-M25X1.5	M12	28	34	10.2	1.5
160M/L	160	254	210/254	108	42	110	12	37	15X19	290	390	φ320	640	2-M32X1.5	M16	35	42	14.2	2

B5 OVERALL & INSTALLATION DIMENSION

Frame	B5					B5R					D	E	F	G	KK	AC	HD	L	SS	XX	ZZ	CC	Y		
	M	N	P	T	S	R	M	N	P	T														S	R
56	φ98	φ80	φ120	3.0	φ7	0						φ9	20	3	7.2	1-M16X1.5	φ120	100/95	195	M3	8	12	2.5	0.5	
63	φ115	φ95	φ140	3.0	φ10	0						φ11	23	4	8.5	1-M16X1.5	φ130	110/102	230	M4	10	15	3.3	0.8	
71**	φ130	φ110	φ160	3.5	φ10	0	φ115	φ95	φ140	3.0	φ10	0	φ14	30	5	11	1-M20X1.5	φ145	117/109	260	M5	12	18	4.2	0.8
80	φ165	φ130	φ200	3.5	φ12	0	φ130	φ110	φ160	3.5	φ10	0	φ19	40	6	15.5	1-M20X1.5	φ165	137	295	M6	16	22	5	1
90S	φ165	φ130	φ200	3.5	φ12	0	φ130	φ110	φ160	3.5	φ10	0	φ24	50	8	20	1-M20X1.5	φ185	145	335	M8	20	25	6.8	1
90L1/L2	φ165	φ130	φ200	3.5	φ12	0	φ130	φ110	φ160	3.5	φ12	0	φ24	50	8	20	1-M20X1.5	φ185	145	365	M8	20	25	6.8	1
100**	φ215	φ180	φ250	4.0	φ15	0	φ165	φ130	φ200	3.5	φ12	0	φ28	60	8	24	1-M20X1.5	φ205	152	400	M10	22	28	8.5	1.5
112	φ215	φ180	φ250	4.0	φ15	0	φ165	φ130	φ200	3.5	φ12	0	φ28	60	8	24	2-M25X1.5	φ230	180	400	M10	22	28	8.5	1.5
132S	φ265	φ230	φ300	4.0	φ15	0	φ215	φ180	φ250	4.0	φ15	0	φ38	80	10	33	2-M25X1.5	φ270	193	510	M12	28	34	10.2	1.5
132M/L	φ265	φ230	φ300	4.0	φ15	0	φ215	φ180	φ250	4.0	φ15	0	φ38	80	10	33	2-M25X1.5	φ270	193	510	M12	28	34	10.2	1.5
160M/L	φ300	φ250	φ350	5.0	φ19	0						φ42	110	12	37	2-M32X1.5	φ320	230	640	M16	35	42	14.2	2	

B14 OVERALL & INSTALLATION DIMENSION

Frame	B14					B14B					D	E	F	G	KK	AC	HD	L	SS	XX	ZZ	CC	Y	
	N	M	P	T	S	R	N	M	P	T														S
56	φ50	φ65	φ80	2.5	M5	0						φ9	20	3	7.2	1-M16X1.5	φ120	100/95	195	M3	8	12	2.5	0.5
63	φ60	φ75	φ90	2.5	M5	0	φ80	φ100	φ120	3.0	M6	φ11	23	4	8.5	1-M16X1.5	φ130	110/102	230	M4	10	15	3.3	0.8
71**	φ70	φ85	φ105	2.5	M6	0	φ95	φ115	φ140	3.0	M8	φ14	30	5	11	1-M20X1.5	φ145	117/109	260	M5	12	18	4.2	0.8
80	φ80	φ100	φ120	3.0	M6	0	φ110	φ130	φ160	3.5	M8	φ19	40	6	15.5	1-M20X1.5	φ165	137	295	M6	16	22	5	1
90S	φ95	φ115	φ140	3.0	M8	0	φ110	φ130	φ160	3.5	M8	φ24	50	8	20	1-M20X1.5	φ185	145	335	M8	20	25	6.8	1
90L1/L2	φ95	φ115	φ140	3.0	M8	0	φ110	φ130	φ160	3.5	M8	φ24	50	8	20	1-M20X1.5	φ185	145	365	M8	20	25	6.8	1
100**	φ110	φ130	φ160	3.5	M8	0	φ130	φ165	φ200	3.5	M10	φ28	60	8	24	1-M20X1.5	φ205	152	400	M10	22	28	8.5	1.5
112	φ110	φ130	φ160	3.5	M8	0	φ130	φ165	φ200	3.5	M10	φ28	60	8	24	2-M25X1.5	φ230	180	400	M10	22	28	8.5	1.5
132S	φ130	φ165	φ200	3.5	M10	0	φ180	φ215	φ250	4.0	M12	φ38	80	10	33	2-M25X1.5	φ270	193	510	M12	28	34	10.2	1.5
132M/L	φ130	φ165	φ200	3.5	M10	0	φ180	φ215	φ250	4.0	M12	φ38	80	10	33	2-M25X1.5	φ270	193	510	M12	28	34	10.2	1.5

** : This frame size has two housing size, the rated output is for normal "L" size, and increased output is for the bigger "L" size (refer to the figures in the bracket "()")

IMB35

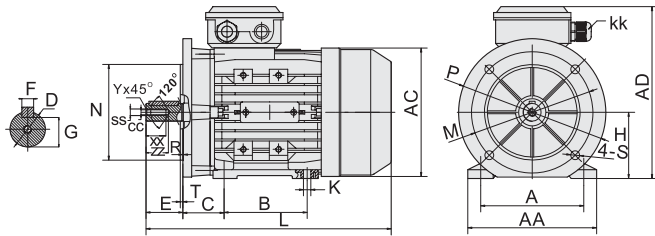

IMB34

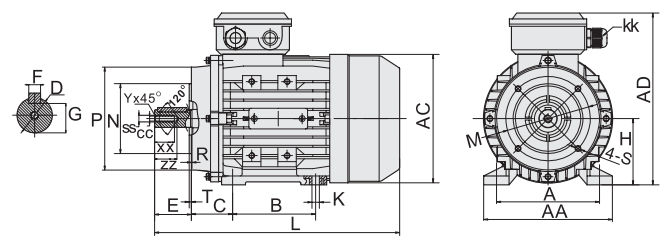

B35 OVERALL & INSTALLATION DIMENSION

Frame	H	B35							B35R					A	B	C	D	E	F
		M	N	P	T	R	S	N	M	P	T	R	S						
56	56	φ 98	φ 80	φ 120	3.0	0	φ 7							90	71	36	9	20	3
63	63	φ 115	φ 95	φ 140	3.0	0	φ 10							100	80	40	11	23	4
71**	71	φ 130	φ 110	φ 160	3.5	0	φ 10	φ 95	φ 115	φ 140	3.0	0	φ 10	112	90	45	14	30	5
80	80	φ 165	φ 130	φ 200	3.5	0	φ 12	φ 110	φ 130	φ 160	3.5	0	φ 10	125	100	50	19	40	6
90S	90	φ 165	φ 130	φ 200	3.5	0	φ 12	φ 110	φ 130	φ 160	3.5	0	φ 12	140	100	56	24	50	8
90L1/L2	90	φ 165	φ 130	φ 200	3.5	0	φ 12	φ 110	φ 130	φ 160	3.5	0	φ 12	140	125	56	24	50	8
100**	100	φ 215	φ 180	φ 250	4.0	0	φ 15	φ 130	φ 165	φ 200	3.5	0	φ 12	160	140	63	28	60	8
112	112	φ 215	φ 180	φ 250	4.0	0	φ 15	φ 130	φ 165	φ 200	3.5	0	φ 12	190	140	70	28	60	8
132S	132	φ 265	φ 230	φ 300	4.0	0	φ 15	φ 180	φ 215	φ 250	4.0	0	φ 15	216	140	89	38	80	10
132M/L	132	φ 265	φ 230	φ 300	4.0	0	φ 15	φ 180	φ 215	φ 250	4.0	0	φ 15	216	178	89	38	80	10
160M/L	160	φ 300	φ 250	φ 350	5.0	0	φ 19							254	210/254	108	42	110	12

Frame	G	K	KK	AA	AD	AC	L	SS	XX	ZZ	CC	Y
56	7.2	5.8X5.8	1-M16X1.5	110	156/151	φ120	195	M3	8	12	2.5	0.5
63	8.5	7X10	1-M16X1.5	120	173/165	φ130	230	M4	10	15	3.3	0.8
71**	11	7X10	1-M20X1.5	132	188/180	φ145	260	M5	12	18	4.2	0.8
80	15.5	10X13	1-M20X1.5	160	217	φ165	295	M6	16	22	5	1
90S	20	10X13	1-M20X1.5	175	235	φ185	335	M8	20	25	6.8	1
90L1/L2	20	10X13	1-M20X1.5	175	235	φ185	365	M8	20	25	6.8	1
100**	24	10X13	1-M20X1.5	196	252	φ205	400	M10	22	28	8.5	1.5
112	24	12X16	2-M25X1.5	220	292	φ230	400	M10	22	28	8.5	1.5
132S	33	12X16	2-M25X1.5	252	325	φ270	510	M12	28	34	10.2	1.5
132M/L	33	12X16	2-M25X1.5	252	325	φ270	510	M12	28	34	10.2	1.5
160M/L	37	15X19	2-M32X1.5	290	290	φ320	640	M16	35	42	14.2	2

B34 OVERALL & INSTALLATION DIMENSION

Frame	H	B34							A	B	C	D	E	F	G	K	KK	
		M	N	P	T	R	S	N										M
56	56	φ 65	φ 50	φ 80	2.5	0	M5		90	71	36	φ 9	20	3	7.2	5.8X5.8	1-M16X1.5	
63	63	φ 75	φ 60	φ 90	2.5	0	M5	φ 90	φ 100	100	80	40	φ 11	23	4	8.5	7X10	1-M16X1.5
71**	71	φ 85	φ 70	φ 105	2.5	0	M6	φ 95	φ 115	112	90	45	φ 14	30	5	11	7X10	1-M20X1.5
80	80	φ 100	φ 80	φ 120	3.0	0	M6	φ 110	φ 130	125	100	50	φ 19	40	6	15.5	10X13	1-M20X1.5
90S	90	φ 115	φ 95	φ 140	3.0	0	M8	φ 110	φ 130	140	100	56	φ 24	50	8	20	10X13	1-M20X1.5
90L1/L2	90	φ 115	φ 95	φ 140	3.0	0	M8	φ 110	φ 130	140	125	56	φ 24	50	8	20	10X13	1-M20X1.5
100**	100	φ 130	φ 110	φ 160	3.5	0	M8	φ 130	φ 165	160	140	63	φ 28	60	8	24	10X13	1-M20X1.5
112	112	φ 130	φ 110	φ 160	3.5	0	M8	φ 130	φ 165	190	140	70	φ 28	60	8	24	12X16	2-M25X1.5
132S	132	φ 165	φ 130	φ 200	3.5	0	M10	φ 180	φ 215	216	140	89	φ 38	80	10	33	12X16	2-M25X1.5
132M/L	132	φ 165	φ 130	φ 200	3.5	0	M10	φ 180	φ 215	216	178	89	φ 38	80	10	33	12X16	2-M25X1.5

Frame	B34B				AC	AD	AA	L	SS	XX	ZZ	CC	Y
	P	T	R	S									
56					φ 120	156/151	110	195	M3	8	12	2.5	0.5
63	φ 120	3.0	0	M6	φ 130	173/165	120	230	M4	10	15	3.3	0.8
71**	φ 140	3.0	0	M8	φ 145	188/180	132	260	M5	12	18	4.2	0.8
80	φ 160	3.5	0	M8	φ 165	217	160	295	M6	16	22	5	1
90S	φ 160	3.5	0	M8	φ 185	235	175	335	M8	20	25	6.8	1
90L1/L2	φ 160	3.5	0	M8	φ 185	235	175	365	M8	20	25	6.8	1
100**	φ 200	3.5	0	M10	φ 205	252	196	400	M10	22	28	8.5	1.5
112	φ 200	3.5	0	M10	φ 230	292	220	400	M10	22	28	8.5	1.5
132S	φ 250	4.0	0	M12	φ 270	325	252	510	M12	28	34	10.2	1.5
132M/L	φ 250	4.0	0	M12	φ 270	325	252	510	M12	28	34	10.2	1.5

:This frame size has two housing size, the rated output is for normal "L" size, and increased output is for the bigger "L" size (refer to the figures in the bracket "()")